

# PocketChem Printer

## Operating Manual

---

Thank you for purchasing the PocketChem printer.

Read this manual thoroughly before use.

For further details, please refer to the operating manual that came with the PocketChem.

If you have had or could have had any serious incident related to the device, please report it directly to the manufacturer or through the authorised representative and to your local regulatory authority.

## Intended purpose

---

PocketChem Printer is a dedicated thermal recording printer for use with PocketChem BA (PA-4140) and PocketChem UA (PU-4010), which are intended for the qualitative, semi-quantitative and/or quantitative measurement of several physiological markers. For *in vitro* diagnostic use and professional use only. This instrument is not intended for near-patient testing use.

This product conforms to the EMC Standard IEC61326-2-6:2012(EN61326-2-6:2013).

Class of emission: CISPR 11 Class A

This instrument is IVD medical instrument.



This product conforms to Regulation (EU) 2017/746.

**NOTE:** This equipment has been tested and found to comply with the limits for a Class A digital device, pursuant to part 15 of the FCC Rules. These limits are designed to provide reasonable protection against harmful interference when the equipment is operated in a commercial environment. This equipment generates, uses and can radiate radio frequency energy and, if not installed and used in accordance with the instruction manual, may cause harmful interference to radio communications. Operation of this equipment in a residential area is likely to cause harmful interference in which case the user will be required to correct the interference at his own expense.

The electromagnetic environment should be evaluated prior to operation of the device. Do not use this device in close proximity to sources of strong electromagnetic radiation, as these may interfere with the proper operation.



**The printer must be directly attached to the instrument in order to use it. Therefore, the printer can also be contaminated by pathogenic microorganisms. Take care when attaching, detaching and storing the printer to prevent exposure to pathogenic microorganisms.**

## Symbols

The following symbols are used in this manual and the labels on this instrument to call your attention to specific items.

### ■ For Your Safety



**Follow the instructions given here to prevent exposure to pathogenic microbes.**

## Unpacking

The package should contain the components listed below. Check to see if everything is included. If anything is missing or damaged, contact your distributor.

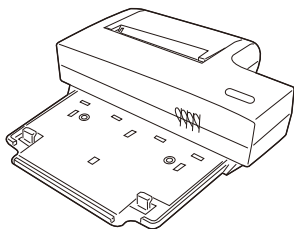

■ PocketChem printer



■ Stylus pen  
(Stored in the printer)



■ Printer paper



■ Operating manual  
(this manual)

## Materials Required but Not Provided

- PocketChem BA PA-4140
- PocketChem UA PU-4010
- Power code
- AC adapter

## Printer Specifications

Printer	Thermal recording printer
Printer paper	High color development thermal paper (W58 mm × Ø26 mm)
Operating environment	Temperature: 10-35°C; Humidity: 25-85% RH
Measurement environment	Temperature: 10-35°C; Humidity: 25-85% RH
Storage environment	Temperature: 1-35°C; Humidity: 20-85% RH (Non-condensing)
Environment during transport	Temperature: -10-60°C; Humidity: 20-85% RH (Non-condensing)
Dimensions	125 (W) × 133 (D) × 36 (H) mm
Weight	180 g (without printer paper)
Power supply	AC adapter 7.5 V 3 A
Power consumption	20 W
Attachment	One-touch attachment
Connection	Contact
Expected life	5 years from first use (installation) of instrument (according to company data)

## For Use

Follow the procedure below to attach/detach the printer to/from the instrument. This operating manual uses the PocketChem UA (PU-4010) as an example. For further details, please refer to the operating manual that came with the PocketChem.

**NOTE:** Turn off the power and disconnect the AC adapter from the AC outlet before attaching or detaching the printer. Failure to do so may cause damage to the instrument and printer. The printer may print nonsense if it is accidentally attached or detached while connected to the AC outlet. However, this does not mean that there is something wrong with the printer.

## ■ How to Attach

**NOTE:** The printer runs on AC power only, not on batteries.

Once the printer is attached to the instrument, connect the instrument through the printer to an AC outlet.

1. Place the instrument onto the printer at an angle as shown in the figure.
2. Press the top of the instrument to snap it into place.
3. Make sure the top of the instrument and printer are horizontally level with one another and that both units are firmly locked to each other.

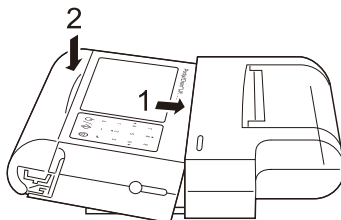

## ■ How to Detach

1. Place the instrument on a level surface (such as a desk).
2. While pressing on the casing above the display at a point aligned with the center of the display (a), lift up the reading unit cover from the bottom (b).

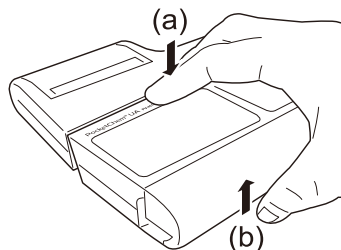

ARKRAY Factory, Inc.

1480 Koji, Konan-cho, Koka-shi  
Shiga 520-3306, JAPAN

[https://www.arkray.co.jp/script/mailform/afc-contact\\_eng](https://www.arkray.co.jp/script/mailform/afc-contact_eng)



ARKRAY Europe, B.V.

Prof. J.H. Bavincklaan 2  
1183 AT Amstelveen, THE NETHERLANDS

If you need to obtain technical assistance,  
please contact ARKRAY Europe, B.V.

TEL: +31-20-545-24-50  
FAX: +31-20-545-24-59



UK RESPONSIBLE PERSON

ARKRAY Ltd.

Beacon House Stokenchurch Business Park, Ibstone Road  
Stokenchurch, High Wycombe HP14 3FE, UK  
<http://Arkray.co.uk>

